

Technical Information



7878 Brighton Road

Brighton, Michigan 48116

810-299-4130

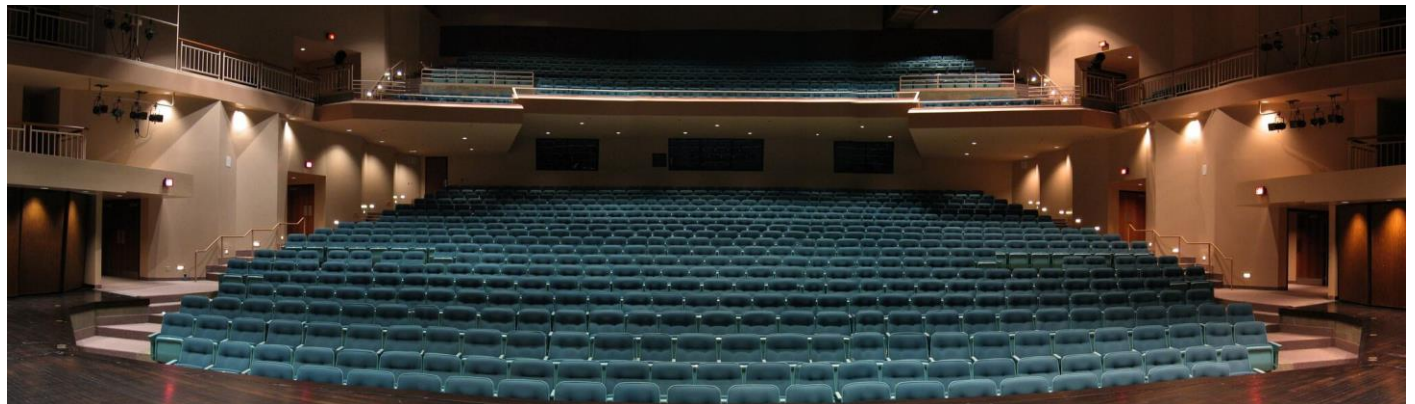

As of 2 September August 2020
Ken Balazovich, Technical Director

Contact Information

Ken Balazovich Technical Director

balazovichk@brightonk12.com

Diane Castillo Accounts Manager and Administrative Assistant, Community Education

castillod@brightonk12.com

Seating

Total capacity 899

Main floor 662

Balcony 237

Wheelchair 25 (part of the 899 total)

Elevator to the balcony level is located near the lobby doors

Brighton Center is completely wheelchair accessible, including cut down curbs

Ticketing

Through Arts People and Neon One

A ticket booth is available for ticket sales

A ticket agent can be arranged for an hourly fee

Ticket booth opens one hour before curtain call

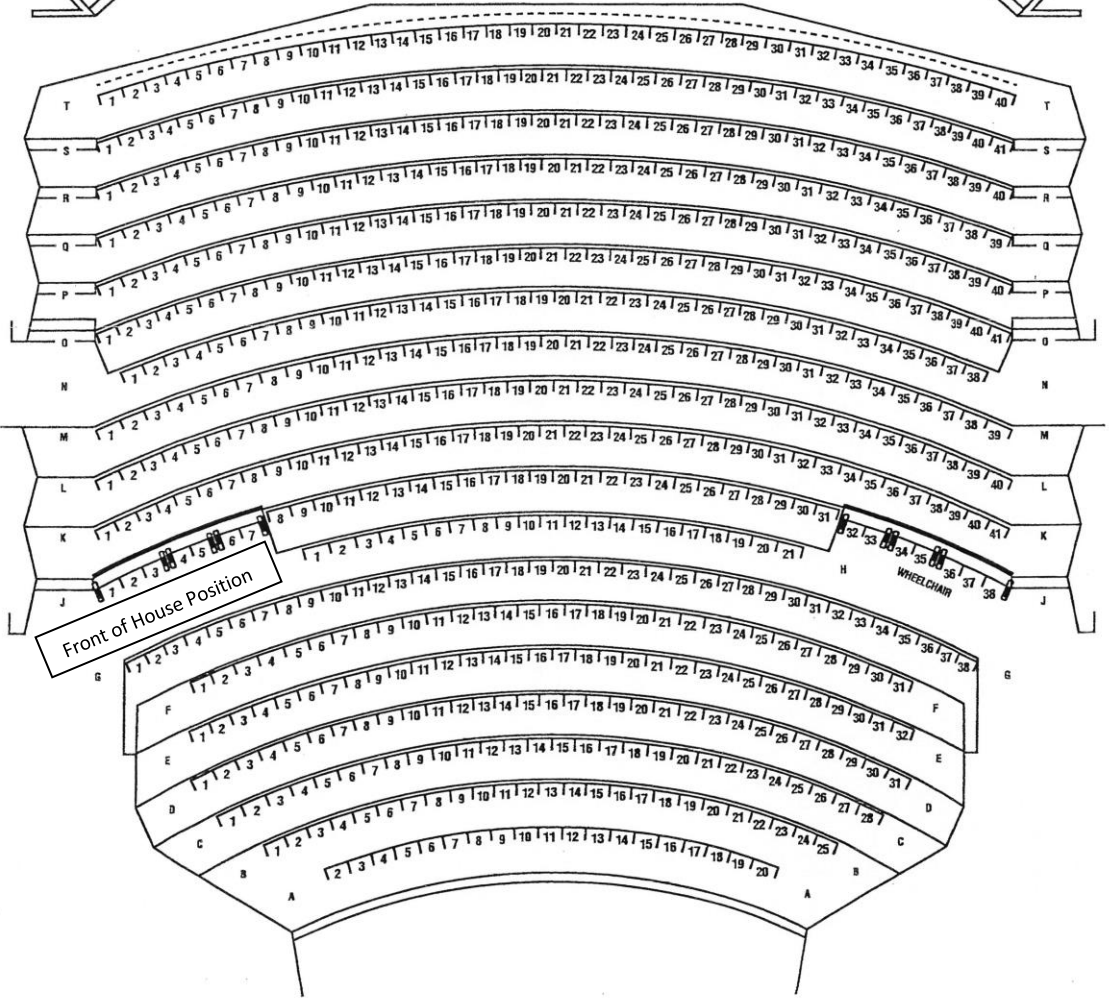
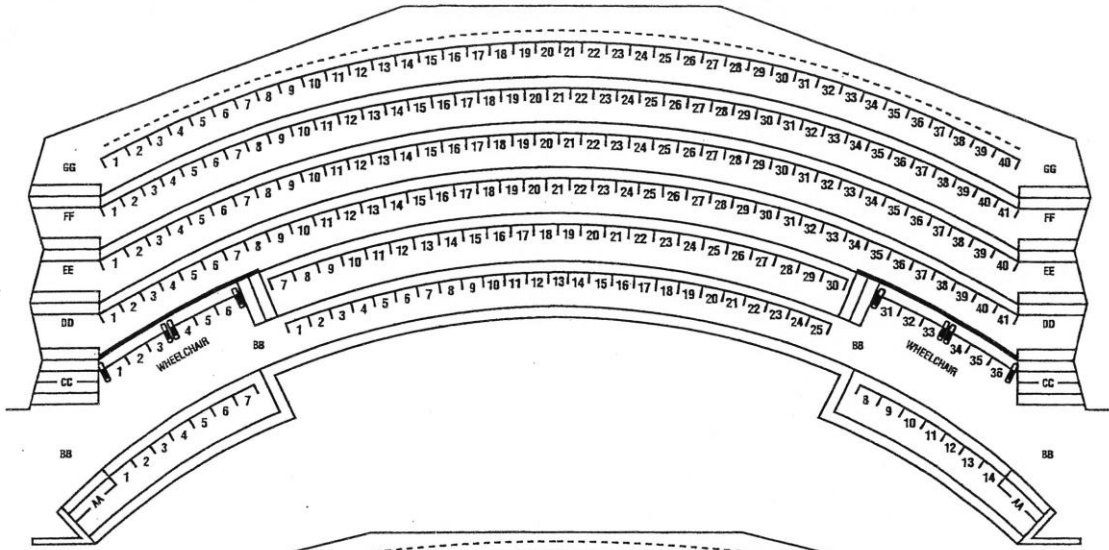

Loading Areas

Stage pedestrian door and ground level loading doors (door 60) are located at the northwest corner of the building

The loading area can accommodate two 53' semi-trucks or road coaches side-by-side

- 120V power is available to the truck parking area

The loading door is located approximately 51 feet from the stage left surface in a direct line

- Outer and inner loading doors are a minimum of 11'8" wide and 11'10" high

The lobby is accessible by pedestrian doors that are approximately 25 feet from the front parking area.

Ample patron parking is available in several fully lighted lots

One 3'x5' flat cart and several furniture moving carts are usually available

Stage Labor and Special Effects

The Brighton Center is not a union-operated venue.

However, house labor for several departments is required for all rentals for the safety of cast and crew and the facilities. The Theater Director will arrange for house crew at need. The standard house crew is one audio technician, one lighting technician and the house Technical Director.

All crew calls and building access are made by the Theater Director

The use of pyrotechnic devices requires on-site inspection by the local Fire Marshall and must be arranged well in advance of the event.

Special effects such as dry ice and wet ice fog, haze, smoke, lasers and other such devices may be permitted but the equipment and specific use in each event must be discussed in detail well in advance of the event and approved by the Theater Director. The safety of all people and the protection of all theater locations is our continual and working goal.

Stage Technical Information and Dimensions

Proscenium with moveable orchestra pit

Proscenium opening is 22' high x 54'8" wide

House curtain to back wall 37'

- An inset area is upstage of the back wall and it measures 10'x48'

House curtain to farthest upstage batten 35'

House curtain to lip center line 18'8"

Distance from right proscenium edge to offstage wall 18'6"

Distance from left proscenium edge to offstage wall 15'3"

Height of stage to main seating floor 3'6"

- Two permanent staircases allow easy access from the stage level to house seats

Distance from stage lip to balcony edge at center line ~54'

Distance from proscenium to box boom (shortest distance) 35'

Distance from stage lip to back wall, main floor ~67'

Distance from stage lip to FOH technical position ~25'

Distance from stage floor to grid 59'

Stage floor is constructed of Masonite over pine and is painted black

- Off stage areas are Masonite and painted dark gray
- No dance flooring is available but it may be possible to rent it locally

Orchestra pit is approximately 12'x59' (max) and can seat about 30 orchestra members (max)

- The pit floor can be lowered to two positions, one that is 44" and one that is 8'6" down from the stage level. Both have access to DMX and Edison outlets.

A limited number of hearing impaired devices are available

Accommodations for side-stage signers for hearing impaired guests may be made

Stage Curtains (specific locations are indicated on the Lineset Schedule)

All house curtains are manually operated from the SR counter-balanced arbors, stage level

House main curtain (deep red) is both guillotine and center opening

Fire curtain

All house curtains are flat black velour, some with traveler trim adjustments

Six pairs of legs that are 13 feet wide at their maximum trim position

Three full stage curtains on travelers

One white cyclorama (non-moveable)

One black scrim (may be moved)

Border curtains downstage of each electric

SR and SL full side tabs on travelers

Fly System

Grid height above the stage 59'

Batten highest draw is 58'6"

Battens are 1 ½" OD pipe and are 58' long

37 operational battens (see the Lineset Schedule for specific positions)

Two arbor loading galleries are located at 25 and 51 feet above the stage surface

Arbor capacity: 2,500 pounds (tentative)

Access to the grid is via a circular stair at SR from the second loading gallery

Pin rail and electric positions at the loading gallery, SR and SL

Four rear D-ring safety harnesses are available

Three permanent electrics operated manually

Stage Electric Access

3-phase tap in (cam locks only)

One at stage level, SL at the inner loading door. 200 amps, 60 hz and 220 V

A 220 volt circuit is available SL at the stage (cast) door

Lighting System and Controls

House Lighting Board: Martin Mac M1

- Located in the production booth.
- Can be moved to FOH if requested in advance

Dimmer per circuit control using ETC Unison Echo dimmer panels Unison Paradigm LightDesigner software.

- 4 universes are available

DMX in and out available at a number of locations on stage, off stage, orchestra pit, FOH catwalks and grid

On stage overhead lighting (See House Lighting Hang plot)

29 Chroma Q Color Force 12

10 Martin Mac Auras

10 Martin Mac Entours

High Sides (torms): 12 ETC Source 4 Lustre + 4 Martin Mac 101

Box Booms

16 Source 4 19 degree Elipsoidals

One each SR and SL at the upper access runway, each with 6 stage pin circuits and one DMX port (dimmer packs for these fixtures are installed)

Additional hang pipe SR and SL at the lower access runway with 6 stage pin connections and one DMX (no fixtures are installed for the house hang)

Catwalk Positions

1st Catwalk

Projection screen (SIZE XXXXXXXXX) control located center, DS

2nd Catwalk

3rd Catwalk

7 ETC Source 4 19 degree elipsoidals

No lighting circuits are available at the balcony rail

Follow spotlights

- Two Lycian Zot 12 located at far left and far right balcony positions
- Two Lycian SuperArc 400 (model 1267) on rolling tripods that can be rented (advanced notice is required)

Additional Inventory

6 Par 54 cans with Edison ends

7 Colortran 6" fresnels (750 watt)

5 Colortran 8" fresnels (1000 watt)

6 Chroma Q Color Force 12

1 Colortran ellipsoidal 19 degree

A number of 2-fers

10 through 50 foot 3-pin stage cables

Several Edison to 3-pin stage turn arounds

A number of lengths of DMX (5-pin) cables

A limited number of gel frames of various sizes plus a number of size A and size

B gobo pattern frames

Several top hats

Six 15' booms on heavy bases

The grid is equipped with 2 DMX positions (universes 1 and 2) plus Edison outlets

Audio System and Controls

House Console: Soundcraft Vi1

JBL Vertech stereo array FOH

2 Danley subwoofers

4 JBL PRX400 monitors

4 JBL SRX812P monitors

5 wired (only one extra beltpack) and 4 wireless Eartec clearcom communication system

Permanent clearcom positions at the lighting and audio consoles, SR, SL and FOH

House real time camera system with video monitors in dressing rooms, in the lobby and in the drama room

Additional Inventory

A number of lengths of cable with XLR ends (6' – 100')

Many different microphone stands, some with adjustable booms

An extensive microphone inventory is available. Contact us for microphone needs.

Shure ULX1-J1 Packs

Shure SLX1 headpiece microphones with earband

2 Pro Co DB-1 direct boxes

3 Pro Co (TradeTools) CB1 direct boxes

1 Rapco CD-100 direct box

RCA to 1/8" headphone jack connectors

Dual and single XLR to 1/8" headphone jack connectors

Audio snakes

2 Whirlwind Mini 6 channel

1 Whirlwind 24 channel

1 Roadmaster 16 channel

CD player: Denon DN-500C

DVD player: Oppo BDP-103D

BCPA Complex Room Information, On and Off Stage

Dressing Rooms

- Hair and makeup room with 12 stations having mirrors, lights and personal storage shelves plus several 6 foot, round work tables
- 1 “female” room with 10 lockers, 3 toilet stalls and shower
- 1 “male” room with 10 lockers, 2 stalls and shower

Drama Room with several tables and chairs

Small Hospitality Room

Cafeteria (a separate reservation is required)

Ticket Booth, locking

Scenic Shop

- 14’ feet high and about 17’ wide by 37’ 4’ long work and storage space between the outer and inner rolling doors
- 12V Power outlets, deep sink, rolling work bench

Note that renters are required to supply their own tools and all props, scenic materials, lighting gels, gaffer tape, spike tape and supplies. We can supply tapes of various kinds at cost. Contact the Technical Director with needs.

The use of BCPA tools is not usually permitted for any builds or repairs, including events for other schools

Donations of tools, hardware, and supplies is strongly encouraged and appreciated to replace those items that are used by other-than BCPA staff. Reciprocal use arrangements may be possible.

Additional Equipment and Supplies

(the use of some items below incurs a charge)

Stage manager station (SR) with 3-color cue light controller (SL and SR) and HDMI input for a computer connection to the onstage monitors . Wired clearcom.

- Assistant Stage Manager station (SL) with wired clearcom and an overhead tv monitor

Steinway 9' grand piano and bench (rental and tuning fees are required)

NEC NP-PH1000U projector (11,000 lumens) mounted permanently in the production booth. It can be used with a user-supplied computer in the booth or onstage

- Projects cleanly to either onstage screen
- Less effective when projecting onto an upstage cyclorama due to the added throw length and angle.

~60 music stands, adjustable height

16 Crowd control stanchions, most having felt ropes or nylon bands

Conductor podia (2) with safety bar

Speaker podia (3 available) with microphone

Diffusion DF-50 USR hazer on a dimmer. (rental fee is required). We have fluid for it.

Portable Risers, grey carpet, 4 heights and all are 4'x'8' with Velcro safety ties

- 5 at 8" and 6 each at 15", 24" and 32"
- Black skirts are available for most units

Full width orchestra shell with several possible configurations. It can be installed at almost any upstage-downstage position (rental fee is required)

6 Choir risers, approx. full width of the orchestra shell and three levels (rental fee is required)

Black chairs, orchestra style, ~100

12 tables, wood grain, 4x8"

2 wooden stools

A number of sand bags

Several A-frame Ladders, 6' to 14'

Six 6'6" wide costume racks with 4 bars each

A number of pieces of safety carpet

FIRST FLOOR

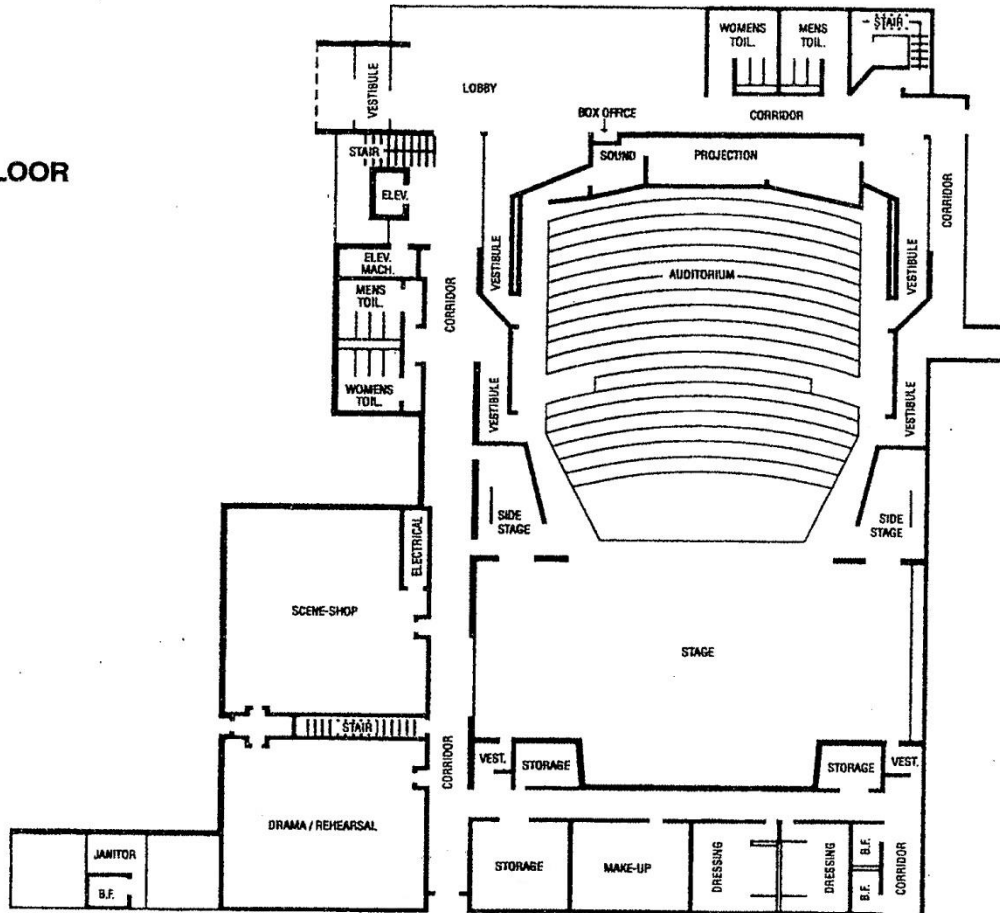

SECOND FLOOR

